



Suncor Energy Inc.
P.O. BOX 2844
150 - 6th Avenue SW
Calgary, AB T2P 3E3

July 2, 2025

Pauline de Jong, Executive Director, OROGO
Office of the Regulator of Oil and Gas Operations
Government of the Northwest Territories
4th Floor Northwest Tower
5201 – 50th Avenue Yellowknife NT
X1A 3S9

Email: OROGO@gov.nt.ca

Dear Mrs. de Jong

Re: Well Operation Reporting for **SUNCOR et al TWEED LAKE M-47 Permit # 1476**

Suncor underwent well operations on M-47 to downhole abandoned the well as per the approved program by OROGO. The downhole operations were from June 11 to June 18, 2025. The operations consisted of running and setting a bridge plug into the well at a depth of 615.0 mKB. The bridge plug was pressure tested to 7 MPa for 15 minutes. There was no change in the pressure over that time. The inhibited fluid was swabbed out of the wellbore and fresh potable water was pumped back into the wellbore.

The cutting a capping operations were conducted on June 18, 2025. The wellhead was cut off using hydrojetting and a vented cap was placed onto the cut casing stub as per OROGO regulations. The hole was back filled.

During any of the operation there were no problems encountered.

Yours Sincerely,

SUNCOR ENERGY INC.

A handwritten signature in black ink, appearing to read "Greg Heffel".

Greg Heffel, P. Eng.
Specialist, Completions



Suncor Energy Inc.
P.O. BOX 2844
150 - 6th Avenue SW
Calgary, AB T2P 3E3

July 7, 2025

Pauline de Jong, Executive Director, OROGO
Office of the Regulator of Oil and Gas Operations
Government of the Northwest Territories
4th Floor Northwest Tower
5201 – 50th Avenue Yellowknife NT
X1A 3S9

Email: OROGO@gov.nt.ca

Dear Mrs. de Jong

Re: Well Operation Reporting for **SUNCOR et al TWEED LAKE M-47 Permit # 1476**

Suncor apologises for the incomplete well operations report for M-47. The bridge plug diagram with technical specification that was used in the operations and the current wellbore diagram have been attached. This should complete the reporting requirements.

Yours Sincerely,

SUNCOR ENERGY INC.

A handwritten signature in black ink, appearing to read "Greg Heffel".

Greg Heffel, P. Eng.
Specialist, Completions

Well Name: Suncor et al Tweed Lake M-47

Date: July 7/25

UWI: 300M476700125450

WA / Licence # 1476

Surface Location: M-47

Latitude: 66° 56' 47.11" N

Longitude: 125° 54' 09.42" W

Elevations									
KB Elevation:		435.22 m		KB-THF		5.52 m		TD 1418.0 mKB	
GL Elevation:		429.10 m		KB-CF:		6.12 m		PBTD 615.0 mKB	
				KB-GL:		6.12 m			
Wellhead:									
Size and Rating									
Manufacturer	mm	x	mm	MPa	x	mm	MPa	x	mm
		x			x			x	
Casing									
	Hole	Joints	OD	Wt.	Grade	Thread	Top	Bottom	
	mm	#	mm	kg/m					
Conductor:	610	2	508	140	K-55	BT&C	7.12	23.0	mKB
Conductor:	445	5	340	101	K-55	BT&C	7.12	64.0	mKB
Surface:	311	61	245	60/65	L-80 / SOO95	LT&C	7.12	760.0	mKB
Production:	216	109	178	43	N-80 / SOO95	LT&C	7.12	1418.0	mKB
Wellbore Fluid:									
Perforations / Open Hole									
Date	Formation	Top	Bottom	BHP	BHT	H₂S	CO₂		
		(mKB)	(mKB)	(kPa)	(°C)	(%)	(%)		
Mar 3/04	Mount Clark (suspended w/ BP & cement)	1222.5	1233.5	12,500	11.5	0.00	0.00		
Perforated with 114 mm ERHSC guns loaded with 38.6 gm Powerjet charges @ 17 spm & 60° phasing									
Bottomhole Equipment Description (from top down) depth in mKB									
Item	Jts	Description	Length	Top					
8		Bridge plug		615	mKB				
1		179 mm x 73 mm EUE Crown 'CTC-1A-EN' tubing hanger with 9.53 mm control line (plugged) and 63.5 mm BPV prep							
2		8 lineal meter cement cap	8.0	1179.8					
3		178 mm 69 MPa permanent bridge plug		1187.8					
4		Halliburton 'HD' on/off connector mandrel w/ 58.75 mm 'X' profile							
5		178 mm x 73 mm EUE Halliburton 'Versaset' retrievable packer with 'HNBR' elements	1.90	1196.00					
6		3.0 m x 73 mm 9.7 kg/m L-80 EUE pup joint c/w two Owen 69 MPa premium permanent bridge plugs	3.09						
7		73 mm EUE x 58.75 mm Halliburton 'XN' nipple w/ 56.01 mm no-go with 58 mm no-go dart for setting bridge plug	0.39	1200.99					
8		98.55 mm OD x 73 mm EUE wireline re-entry guide	0.15						
		Bottom of re-entry guide landed at		1201.53					
Remarks									
Casing Cut 1.0 m below ground level and removed.									
Wellhead and casing cut off on Jun 18th, 2025.									
Well Status Abandoned									
Prepared by Greg Heffel									

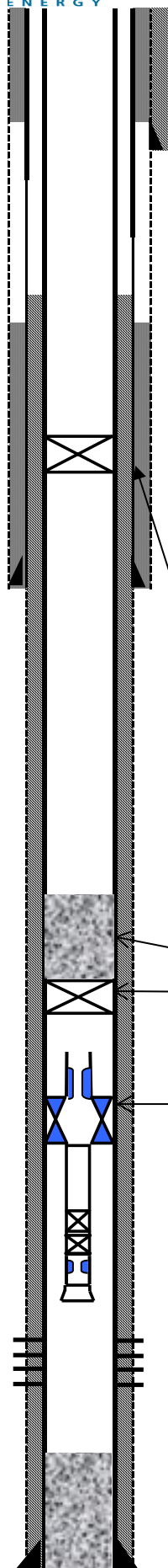

REVISION HISTORY			
Rev.	Description	Date	Approved
01	Initial Release	2017-11-01	CC

CASING SIZE		CASING WEIGHT		PLUG O.D.		MANDREL O.D.		SETTING MIN.		SETTING MAX.		SETTING FORCE		TEMPERATURE	
in	mm	lbs/ft	kg/m	in	mm	in	mm	in	mm	in	mm	lbs	daN	°C	°F
7	177.8	17-35	25.3-52	5.604	142.40	3.688	93.60	6.004	152.50	6.538	166.07	50,000	22,240	150	300

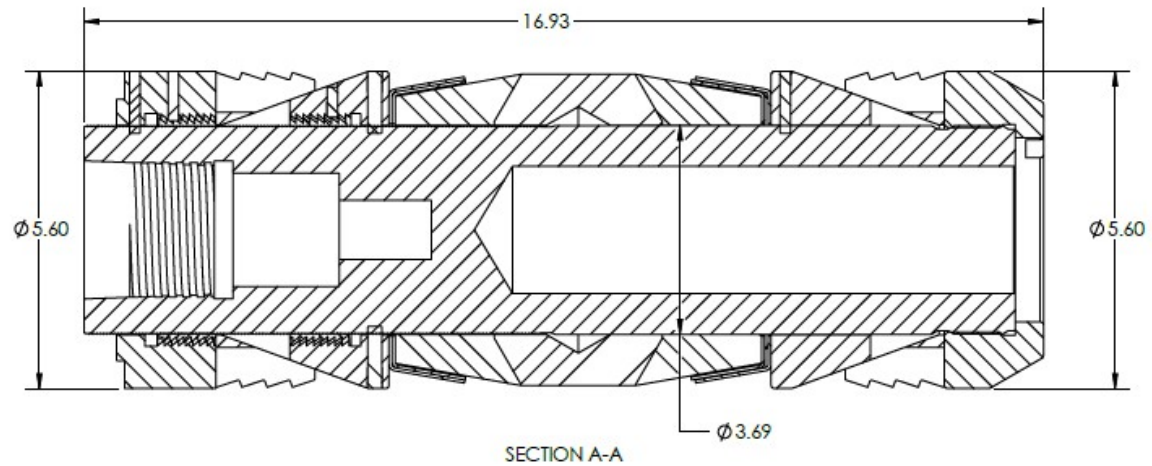
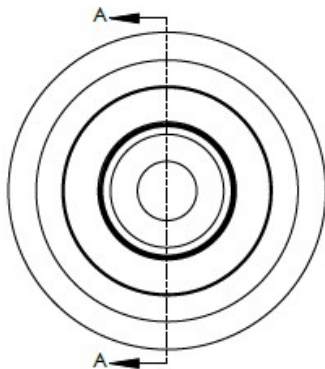

GENERAL TOLERANCES UNO:

FRACTIONAL: $\pm 1/16$
 X..... ± 0.1
 XX..... ± 0.03
 XXX..... ± 0.01
 XXXX..... ± 0.005
 ANGULAR MATCH: $\pm 1^\circ$
 ANGULAR BEND: $\pm 5^\circ$
 MIN. SURFACE FINISH: 125 RMS
 CHAMFERS: 0.015" x 45°
 DEBURR ALL EDGES

MATERIAL:

VARIOUS

HEAT TREAT:

N/A

FINISH:

N/A

DO NOT SCALE DRAWING
IF IN DOUBT ... ASK

DRAWN:

TL

DATE:

2017-11-01

PROPRIETARY AND CONFIDENTIAL

THE INFORMATION
 CONTAINED IN THIS DRAWING
 IS THE SOLE PROPERTY OF
 CANNADAN DOWNHOLE INC.
 ANY REPRODUCTION IN PART
 OR AS A WHOLE WITHOUT THE
 WRITTEN PERMISSION OF
 OWNER OR AUTHORIZED
 AGENT IS PROHIBITED.

TITLE: ASSEMBLY TECH

PROJECT: 7.000 10K BRIDGE PLUG

DWG: 700BP10

WGT: 65.67 lbs

SIZ: 11x17

SHEET: 1 of 1

REV: 01